

POLE BARNS AND STEEL BUILDINGS

DATE _____ PROPERTY CODE _____ PERMIT# _____

Town, Range, Section and Quarter Section: _____

Property Address: _____

Below are minimums – If anything is different, please indicate.

1. Building size: _____ X _____ = Sq Ft _____

2. Foundation

A. Pad: _____ one(1) bag redi-mix _____

B. Depth of poles below grade: _____ 4' below grade _____

C. Floor _____

D. Bottom of plate timbers _____ two(2) 2x6 T&O Treated _____

E. Rat walls need to be 16" deep if unheated and 24" deep if heated or could be attached to residence.

3. Side Walls

A. Height: _____

B. Poles _____ Size 4"x6" - 6"x6" at door openings _____

C. Spacing _____ 8' 0" _____

D. Headers: _____ two(2) 2' x 10" minimum _____

E. Purlins _____ 2"x 4" _____

F. Spacing _____ 8' OC _____

G. Exterior Finish _____

4. Roof

A. Rafters _____ Engineered Truss _____

B. Purlins _____ 2"x4" _____

C. Spacing _____ 24" OC _____

D. Bracing _____ 2"x4" (gable ends) _____

E. Sheathing _____ 8' OC _____

F. Roofing _____ Type _____

5. Load Weights

A. Roof _____ 50 # snow load _____

6. Windows

A. Size _____

7. Doors

A. Size _____

B. Headers _____

8. Plot Plan must show all buildings located on the property and number of feet from one building to the other and also the number of feet from the lot lines and all four sides.

Please submit this information to assist staff in locating your project site. This will avoid delays in processing your inspections because staff cannot locate your project site. This page is in addition to the site location map.

11. ADDRESS INFORMATION:

Township	Town	Range	Section
Property Address			
Where is Address Visible? <input type="checkbox"/> House <input type="checkbox"/> Garage <input type="checkbox"/> Mailbox <input type="checkbox"/> Sign			
Name of Access Road to Project?			
Road Type: <input type="checkbox"/> Paved <input type="checkbox"/> Gravel <input type="checkbox"/> Public <input type="checkbox"/> Private <input type="checkbox"/> Seasonal			
Name of Nearest Crossroad:			
Distance to this Road (in Miles and Tenths):			

Please add driving directions and/or legible map in the space provided on this sheet.

Property Owner Signature:			
Mailing Address:			
City	State	Zip Code	Telephone:
Contractor's Signature:			
Mailing Address:			
City	State	Zip Code	Telephone:

CRAWFORD COUNTY DEPARTMENT OF BUILDING SAFETY INSPECTION
PROCEDURES REQUIRED--IMPORTANT NOTICE

The County of Crawford Building Department Inspectors, in accordance with the Code of the State of Michigan and the Ordinance of the County of Crawford, must inspect all building projects in the logical and sequential order below:

1. **Footing Inspection:** Upon footings being completely formed, do not pour concrete until approved by inspection you must call for.
2. **Back Fill Inspection:** Basement/Crawl Space requires wall damp proof inspection which is done after the blocks are laid, damp proof sealed and approved by inspection before backfilling.
3. **Rough Inspection:** Before walls are enclosed or insulated, verify house wrap, window and door flashings, verify roof felt and ice-guard, verify truss engineering to inspector prior to inspection, rough inspections by mechanical, plumbing and electrical inspectors must be complete and documented-approved.
4. **Insulation Inspection:** Before walls are enclosed, Install attic cards for insulation value, no paper exposed on insulation to any open areas.
5. **Final Inspection:** When construction is complete and before building is occupied. Final inspections by mechanical, plumbing and electrical inspectors must be complete and documented-approved.
6. **Accessory Buildings:** Requires inspections #1 and #5 and/or more as required.

A **Temporary Certificate of Occupancy** requires re-inspection of all corrections plus a re-inspection fee.

A **Certificate of Occupancy** must be issued before building is occupied.

All re-inspections for Building, Electrical, Mechanical and Plumbing require payment of the fee for additional inspection prior to re-scheduling.

The Crawford County Building inspector will make every effort to inspect your project in a timely manner. However, if it is not possible to inspect upon your immediate request and within your immediate time schedule, it does not mean that you may continue building.

To continue building beyond an inspection level, prior to that inspection, will cause a STOP WORK ORDER to be placed on your building project until that inspection can be properly performed.

[APPLICANT, BUILDER, OWNER IS RESPONSIBLE TO VERIFY ALL INSPECTIONS ARE CALLED FOR]

Date _____

Owner's/Contractor's Signature

I have been informed of the above stated **Inspection Policy**.

SOIL BEARING CAPACITY (PSF)

1500 ___ - Clays- Sandy, Silty, Clayey, Silt, Sandy Silt ___
2000 ___ - Sand- Silty, Clayey, Silty, Clayey Gravel ___
3000 ___ Gravel, Sandy Gravel ___

GROUND SNOW LOADS (PG)

60 ___ N W Corner of Maple Forest TWP
50 ___ Crawford County ___

NOTE: All door and window opening locations & sizes.

Note: All door and window header

Concrete for pads to be a minimum compressive strength of 2500 PSI

CONCRETE FLOOR
YES ___
NO ___
THICKNESS ___

Typical Post Spacing

ROOF FRAMING

TRUSSES : ___ YES ___ NO
RAFTERS: SIZE ___
SPACING: ___

NOTE: Engineered Truss, drawings must be provided when pre-manufactured Trusses are used.

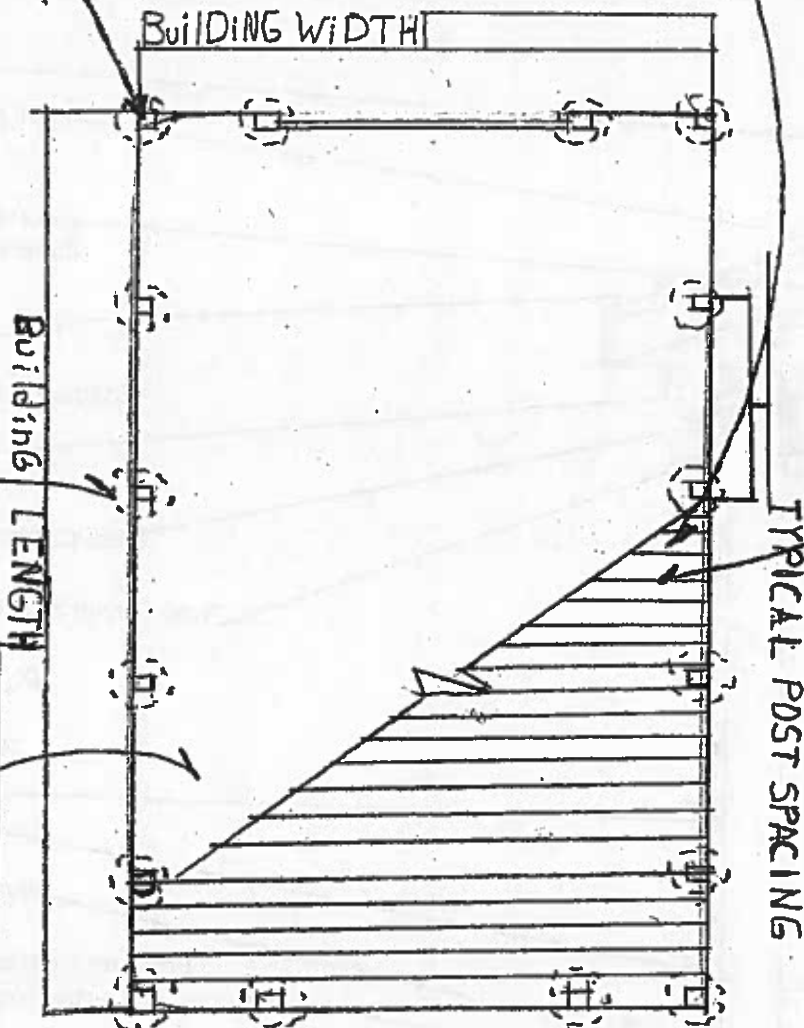

FLOOR PLAN - NOT TO SCALE

Footings shall extend to a minimum depth of 48" below grade or 1/3 of pole length

PERMANENT ROOF BRACING

In order to provide lateral support of engineered Trusses, permanent roof bracing must be applied to all Truss chords per Truss manufacturer's engineered truss drawings.

FASTENERS

Fasteners for preservative treated wood shall be of Hot-Dipped Zinc-Coated Galvanized Steel: Silicon Bronze or Copper

WIND BRACING

Wind bracing is required for buildings with a side wall height of 10'0" or higher. The brace must be a minimum of a 2x4 in size and 12'0" in length. Braces shall be installed at all corners and every 25'0" thereafter braces must extend on an angle from the bottom of the pole to the rafter